

WILDFLOWER SUBDIVISION FILING NO. 1

OVERALL DISTRICT EXHIBIT

A PART OF THE SOUTH 1/2 OF SECTION 27, TOWNSHIP 2 NORTH, RANGE 68 WEST
OF THE 6TH PRINCIPAL MERIDIAN, TOWN OF FREDERICK, COUNTY OF WELD,
STATE OF COLORADO

329.77 ACRES

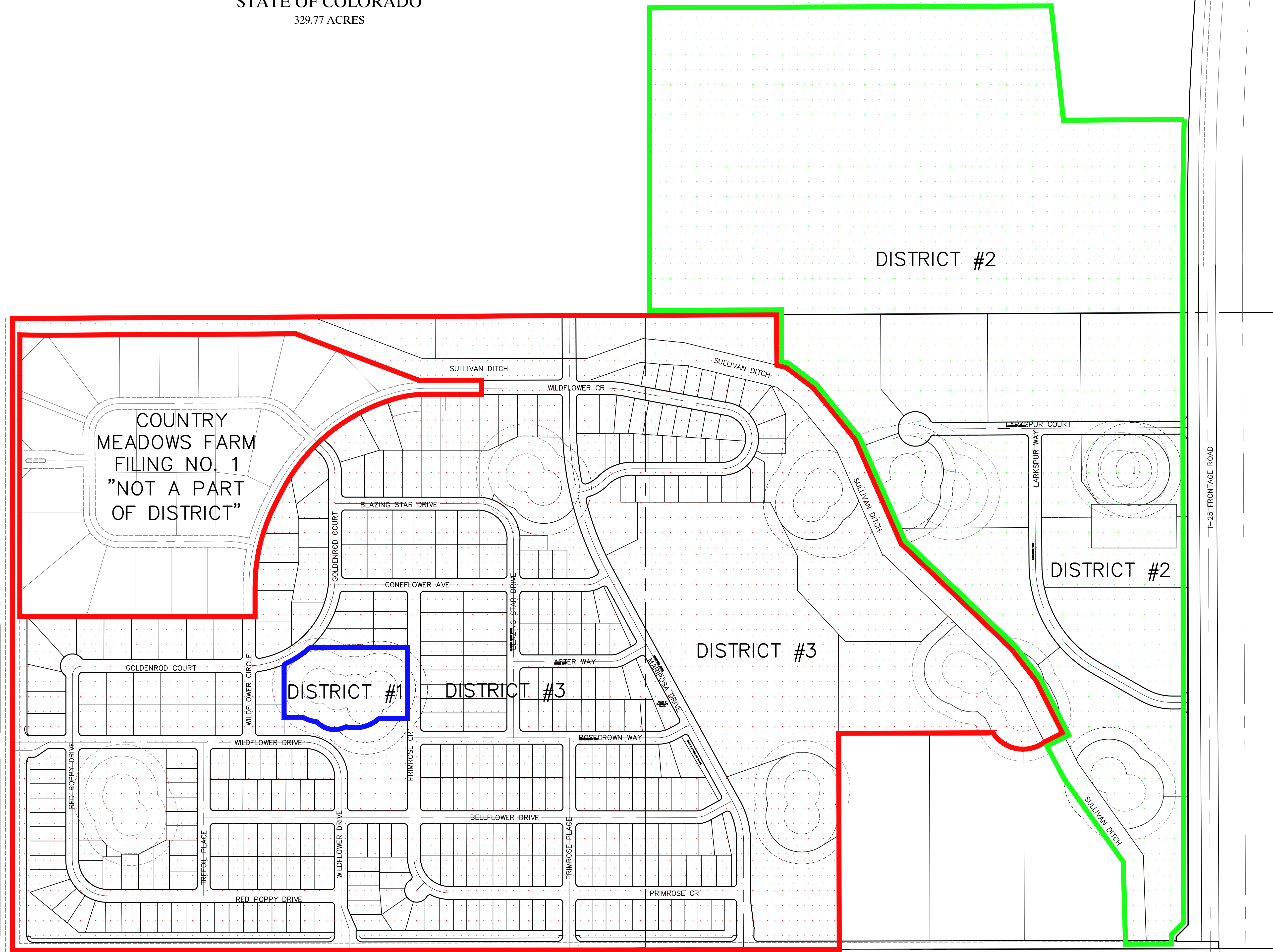

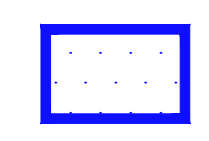
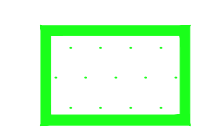
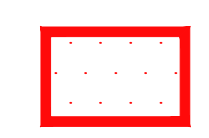
-  DISTRICT #1
-  DISTRICT #2
-  DISTRICT #3

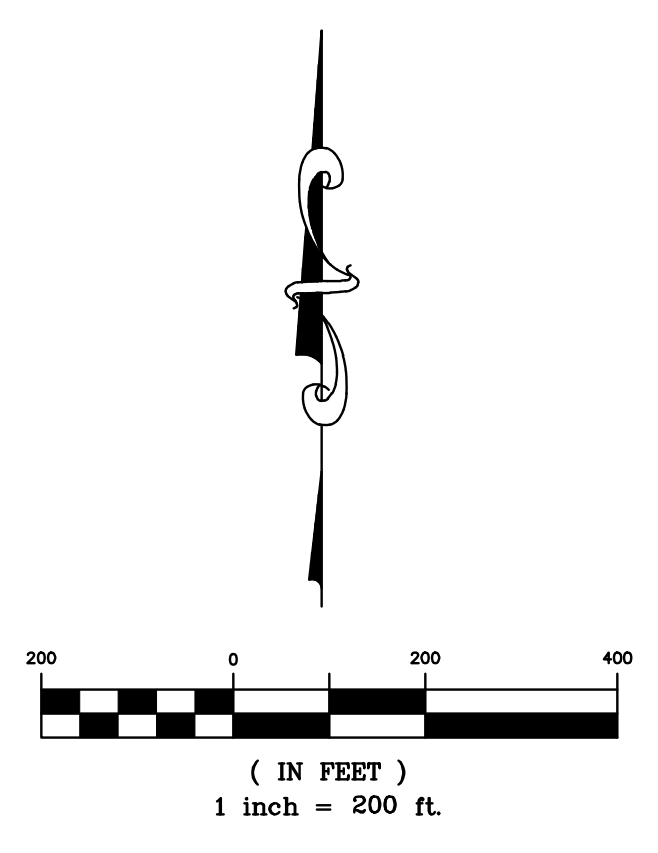

PROJECT NO.: 01.10
DATE: 01/20/2022



ATWELL
866.850.4200 www.atwell-group.com
143 UNION BOULEVARD, SUITE 700
LAKEWOOD, CO 80228
303.462.1100
CONTACT: JEFF FRENCH
JFRENCH@ATWELL-GROUP.COM

CAD FILE: DISTRICT MAP.DWG