

# WILDFLOWER SUBDIVISION FILING NO. 1

## OVERALL DISTRICT EXHIBIT

A PART OF THE SOUTH 1/2 OF SECTION 27, TOWNSHIP 2 NORTH, RANGE 68 WEST  
OF THE 6TH PRINCIPAL MERIDIAN, TOWN OF FREDERICK, COUNTY OF WELD,  
STATE OF COLORADO

329.77 ACRES

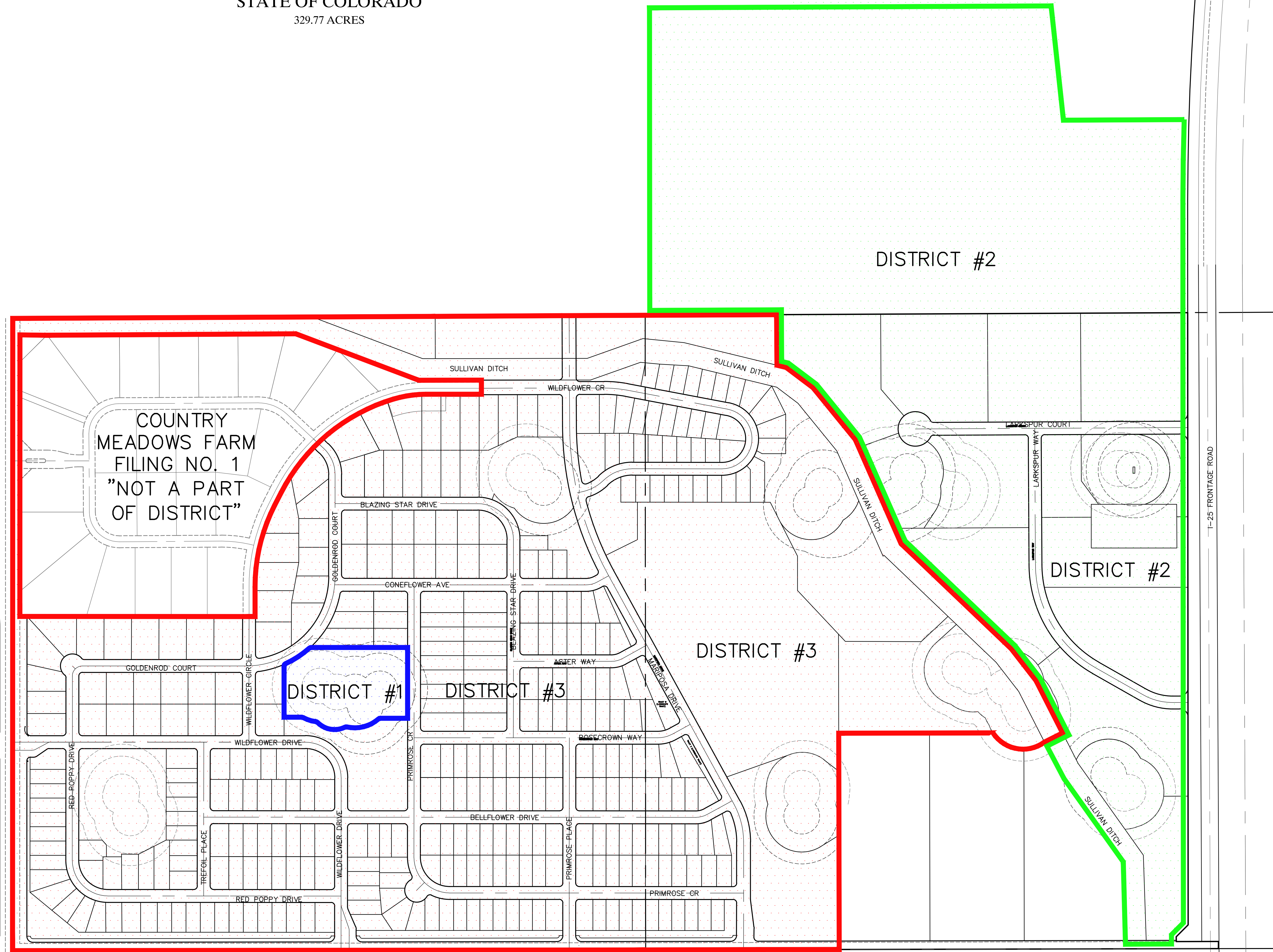

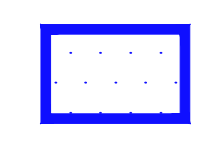
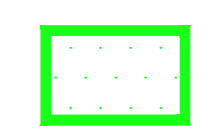
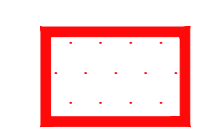
-  DISTRICT #1
-  DISTRICT #2
-  DISTRICT #3

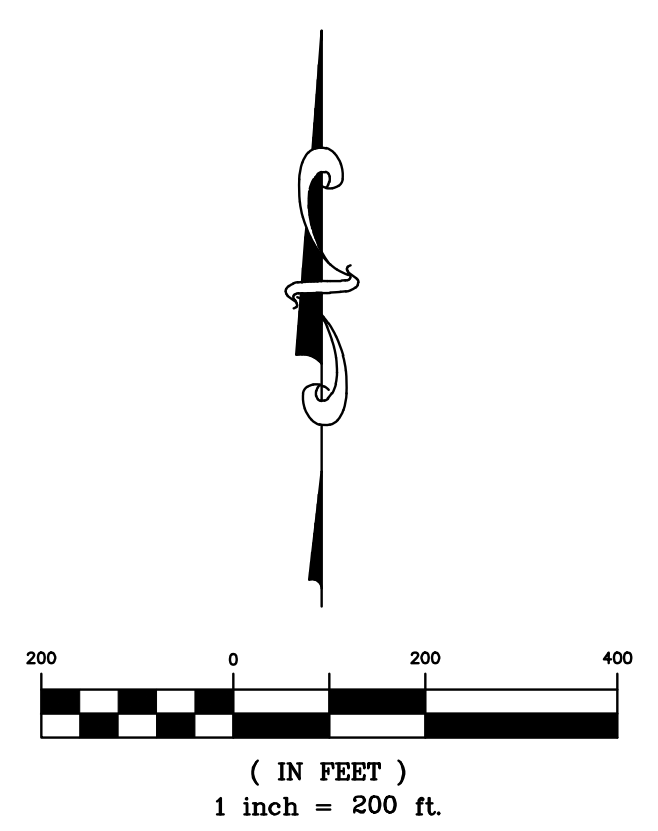

PROJECT NO.: 01.10  
DATE: 01/20/2022



**ATWELL**  
866.850.4200 [www.atwell-group.com](http://www.atwell-group.com)  
143 UNION BOULEVARD, SUITE 700  
LAKEWOOD, CO 80228  
303.462.1100  
CONTACT: JEFF FRENCH  
JFRENCH@ATWELL-GROUP.COM

CAD FILE: DISTRICT MAP.DWG